

# 6000 PSI/414 bar reducing regulator model 7000

## General information

The 7000 model regulator is an economical, piston type, hand load regulator. The maximum inlet pressure is 6000 P.S.I./414 bar with a variable outlet between 0 and 6000 PSI. The regulator seat is protected by a 30 micron filter. The regulator seat Poppet assembly and filter are contained in an easily replaced valve cartridge assembly. The cartridge is factory pre assembled and permits easy replacement in the field. This unit is self venting ,a non venting unit can be supplied to special order. A panel Mounting ring is also available. This unit is exceptionally rugged and insensitive to inlet contaminants due to the simplicity of its design.

## FOR AIR USE ONLY.

## Installation

Use a suitable Teflon or PTFE tape to seal fittings into the regulator using ample tape 3 or 4 turns around the thread. Do not over tighten fittings. We recommend that you use 316 stainless fittings only. A panel mounting ring is available, part number 0750.



As with all regulators a pressure relief valve should always be fitted on the outlet side set slightly above the maximum desired pressure.

Inlet and outlet ports are opposite each other with pressure gauge ports at 60 degrees spacing.

Pressure gauge ports at 60 degrees spacing. All threads are 1/4 NPT.

We can supply suitable fittings from stock or on short delivery times.

## Maintenance

As with any regulator, particulates or moisture can block or freeze the internal filter or seat. Therefore it is important that you check and change your filters regularly. We can supply a complete service kit from stock to enable a quick turnaround. The poppet assembly is factory set and should not be not be stripped out unless absolutely necessary. All maintenance must be carried out in a clean environment. Use appropriate grease for the service required when re-assembling any parts. If in doubt please ask!

## Specifications

|  |   |
|--|---|
| Maximum inlet pressure   | 6000 PSI/414 bar  |
| Maximum outlet pressure  | 6000 PSI/414 bar  |
| <b>Materials</b><br>Body and housing<br>Internals<br><br>Seals | Anodised aluminium<br>Brass and<br>stainless steel<br><br>Viton |
| Size   | 2.25" x 5.5" high   |
| Weight   | 700 grams./1.5 lbs  |
| Inlet and outlet ports   | 1/4 NPT   |
| Gauge ports x 2 –<br>inlet and outlet                          | 1/4 NPT   |

| Model Regulator 7000 |                           |
|----------------------|---------------------------|
| Item                 | Description               |
| 1                    | Body                      |
| 2                    | Poppet cartridge          |
| 3                    | Vent seat                 |
| 4                    | Piston                    |
| 5                    | Piston housing            |
| 6                    | Spring guide – see note 2 |
| 7                    | Cap                       |
| 8                    | Adjusting screw           |
| 9                    | Handwheel                 |
| 10                   | Bearing plate             |
| 11                   | Thrust bearing            |
| 12                   | Outer spring              |
| 13                   | Seal O-ring               |
| 14                   | Seal O-ring               |
| 15                   | Seal O-ring               |
| 16                   | Seal O-ring               |
| 17                   | Lower spring guide        |
| 18                   | No longer used            |
| 19                   | Inner spring              |
| Poppet Cartridge     |                           |
| Item                 | Description               |
| 1                    | Retaining nut             |
| 2                    | Poppet housing            |
| 3                    | Sleeve                    |
| 4                    | Seat                      |
| 5                    | Poppet                    |
| 6                    | Seal O-ring               |
| 7                    | Seal O-ring               |
| 8                    | Spring                    |
| 9                    | Filter 30 Micron          |

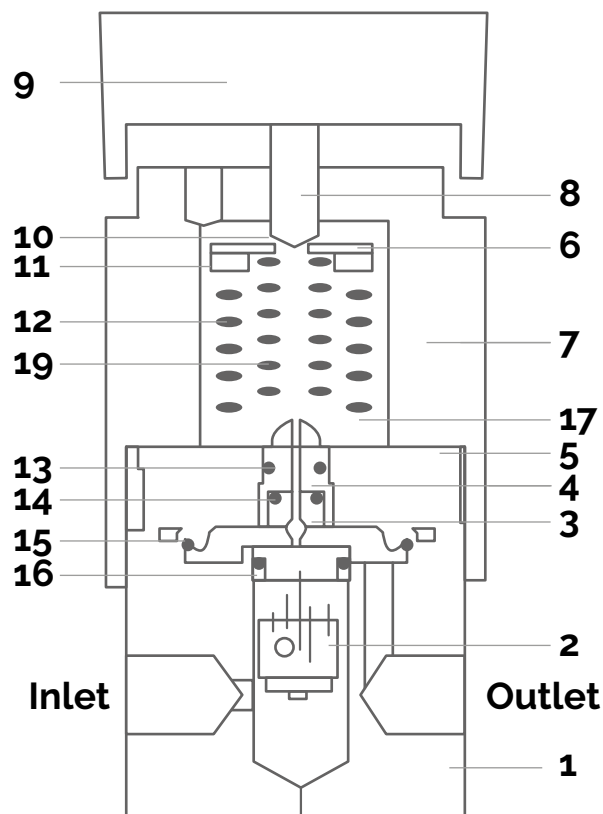

**Model Regulator 7000**

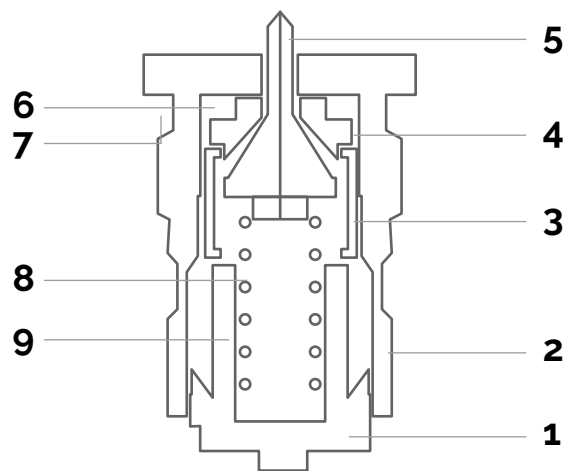

**Poppet cartridge**

## Notes

1. Mount piston housing (5) with smoother side down against O-ring seal.
2. Mount spring guide (6) with bevel side toward adjusting screw.
3. Poppet cartridge (2) includes parts 1 to 9 above ready assembled.
4. Service kit comprises parts: 2, 3, 4, 5, 13, 14, 15 and 16